

- NOTES:
1. Unless otherwise noted, all ducts are 90 mm diameter for 12 x 15mm diameter or 15 x 13 mm diameter strand tendons.
  2. Post-tensioning layouts for balanced cantilever construction using these standards shall utilize the duct and anchorage locations shown. Details shall be in accordance with the "Recommended Contract Administration Guidelines for Design and Construction of Segmental Concrete Bridges".

Segment Depth (mm)	'X' (mm)	'Y' (mm)
1800	4	480
2100	6	800
2400	8	1,120
2700	10	1,440
3000	12	1,760

BULKHEAD HALF SECTION - SERIES 1

BULKHEAD HALF SECTION - SERIES 2

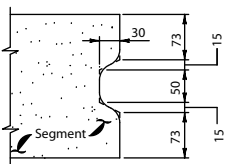

SECTION A-A

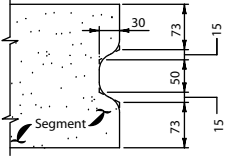

SECTION B-B

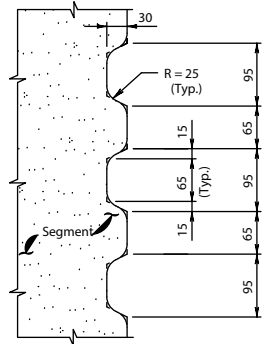

SECTION C-C

AASHTO - PCI - ASBI  
SEGMENTAL BOX GIRDER STANDARDS

FOR BALANCED CANTILEVER CONSTRUCTION  
SPANS 30.5 TO 61.0 METERS

STANDARD BULKHEAD DETAILS